

C55 cap white without seal

**General Information**

Ordering numbers : I47465069V2100017008

Weight : 8.000 gr

**Components**

1 - Couvercle C55 blanc non jointe

Material : MAT.HMA018 MOBIL

Color : C069 (Blanc)



**Neck : G017 (Screwing cap C55)**

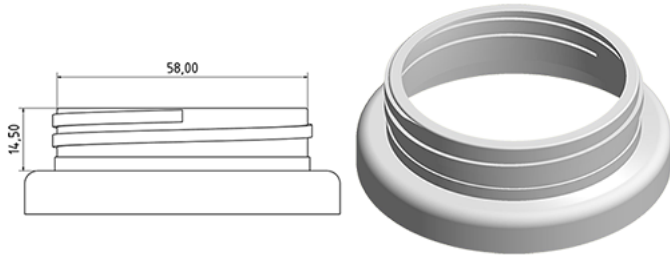

**Standard packaging : V21**

1000 pieces per carton / 30000 pieces per pallet

- pieces loose in the boxes
- 30 Boxes C3
- 1 pallet 100 X 120

X : 38,6 cm - Y : 58,6 cm - Z : 30,7 cm

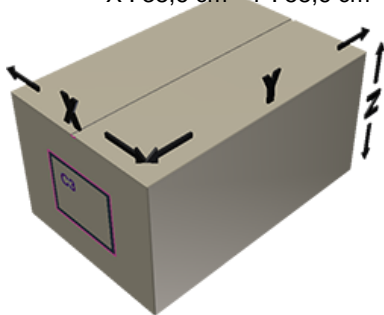

**Media**

